

Calculating Alignment and Slope in X-PAD Ultimate

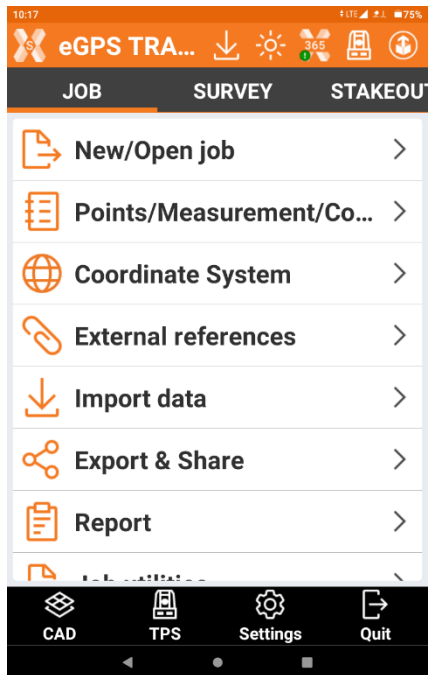

Open a Project in X-PAD Ultimate

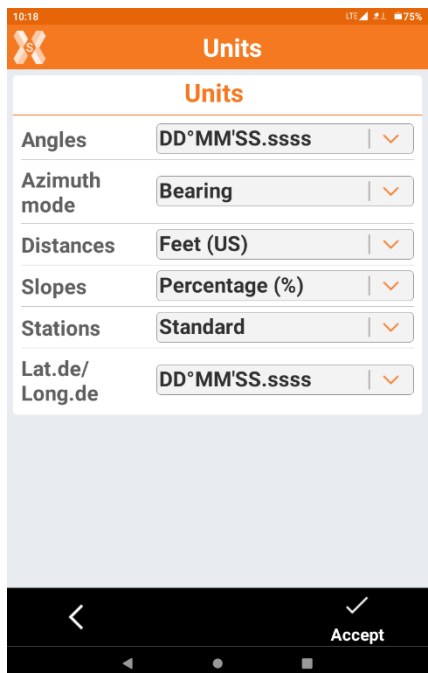

Navigate to Settings / Units.

Ensure the Slopes Setting is set on Percentage (%)

Select Accept.

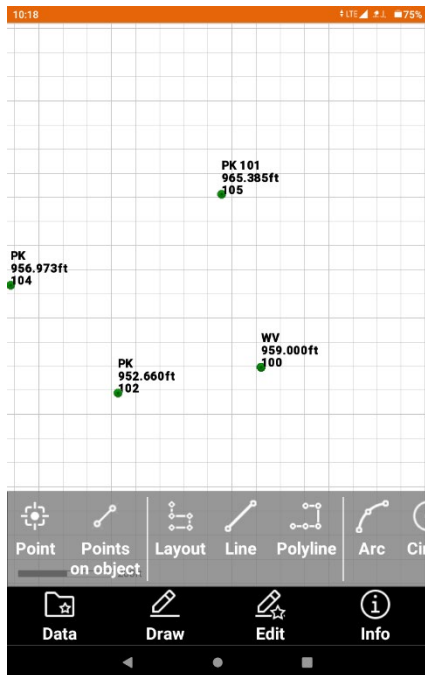

Select the Cad Menu

Select the Draw Command then

Select the Layout Routine

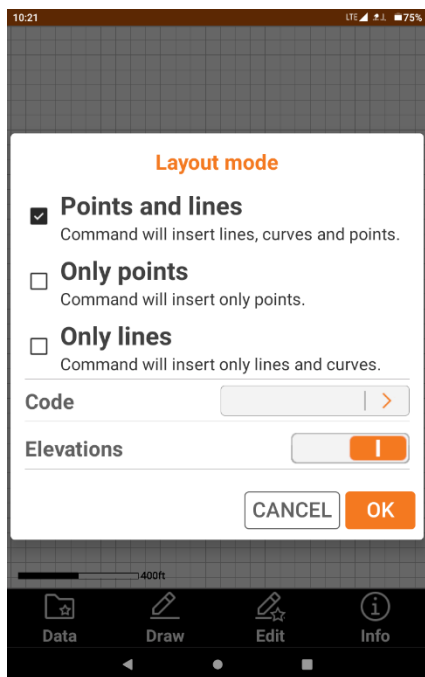

In Layout Mode you can now select your options.

In this example I have selected Points and Lines

Select OK

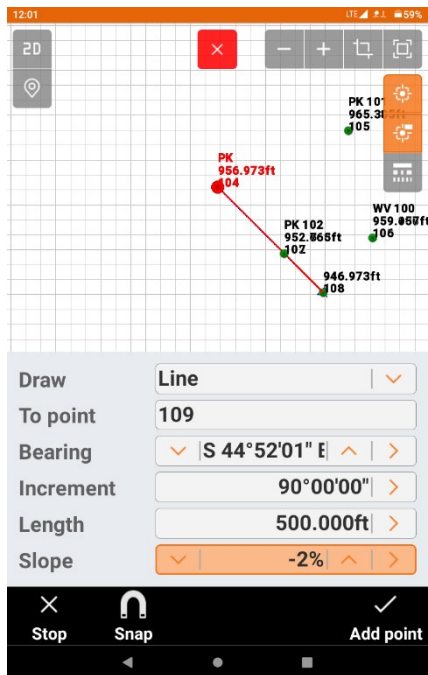

Enter your Parameters

In this example we are using a Line.

Using Points 104 to 102 I computed the Bearing by entering the Point Numbers separated by a comma.

For Increment I did not change from 90 Degrees.

Enter your Length of the Line.

Using the Arrow to the Right Of Elevation will change the parameter to Slope (Percentage) and enter your Percentage of Grade. Use a Minus Symbol for a downhill slope.

I have entered a Slope of -2.00%

Select Add Point.

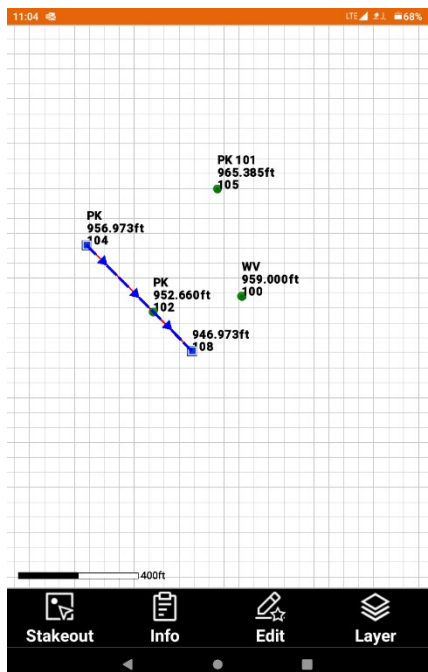

I have now drawn an alignment of 500 feet at a negative 2.0% slope.

Selecting the line on the screen I can see the direction and using the elevation of the first point I can also check to ensure I have the correct amount of difference in elevation.

I am now prepared to stake Point 108, which is the end of my line with the computed elevation at -2.0% slope.